

# SENTI

Cubical Volume

Combines with classical elements with cubical aesthetics.

Executive office SENTI provides different storage solutions such as open file drawers, shelves, sliding door cabinet and an external mobile pedestal to suit your needs.



## Product Specification



Main Table &  
Back Storage

WK-SENTI-01  
Senti table

WK-SENTI-04  
Senti back storage

WK-SENTI-03  
Senti high mobile 3 drawer



# Features

Open Storage

Features with book shelves storage at table front



Leg Base

Metal base with adjustable drawer



Flipper Casing

Designed for the best wire management solution to suit your modern day office needs.



Locking System

Aluminium locking system.



## Dimension

WK-SENTI-01  
Main Table  
2000W x 1800D x 760H MM

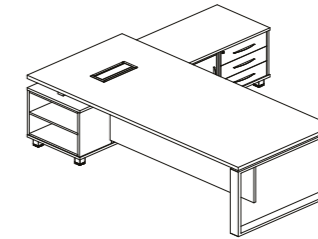

WK-SENTI-04  
Back Storage  
2000W x 520D x 2100H MM

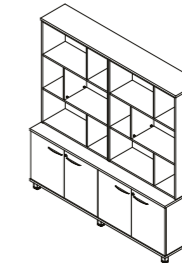

WK-SENTI-03  
High Mobile 3 Drawer  
425W x 490D x 670H MM

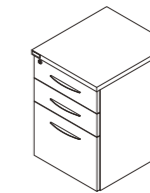

## Material & Colour Option

Melamine  
Laminated  
Chipboard



NOCE  
NOGARO

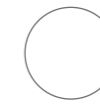

WHITE